

PARCEL A  
AREA=1,133.85 SF  
(SEE NOTE 2)

ALICIA F. MAGRI &  
JOHN A. MAGRI  
BOOK 4189 PAGE 340  
PLAN BOOK 149 PAGE 67

LOT 1  
AREA=82,915.64 SF  
(1.903 ACRES)

LOT 2  
AREA=35,190.91 SF

KENNETH C. LACOSTE &  
PAMELA L. DALTON  
BOOK 6027 PAGE 307  
PLAN BOOK 149 PAGE 67

SATYANANDA GABRIEL &  
ELLA GABRIEL  
BOOK 10486 PAGE 208  
PLAN BOOK 149 PAGE 67

MELHEM SALLIUM  
BOOK 6340 PAGE 83  
PLAN BOOK 52 PAGE 61

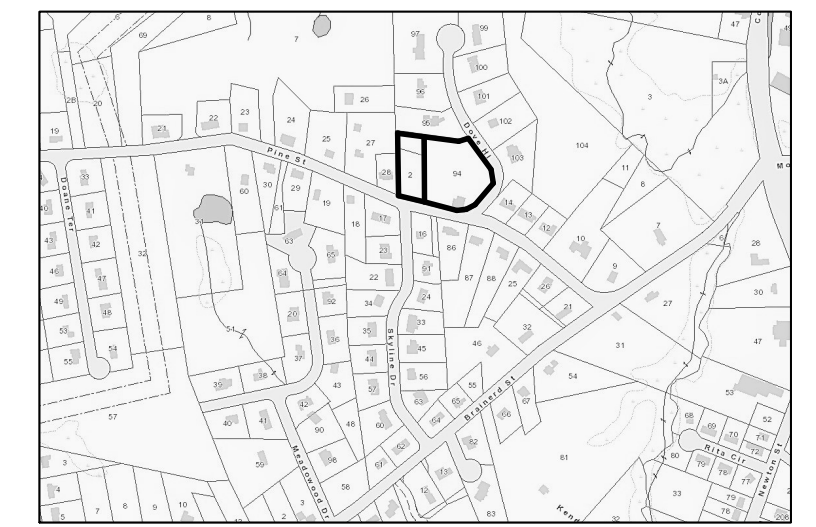

LOCUS  
(NOT TO SCALE)

RESIDENCE A-1 MINIMUM ZONING REQUIREMENTS				
	AREA (S.F.)	LOT FRONTAGE (FT.)	MAX. BUILDING COVERAGE (%)	MAX. IMPERVIOUS COVERAGE (%)
R A-1	22,500	125	30	60

- NOTES:
- FOR REFERENCE TO ENCLOSED PERIMETER SEE BOOK 1443 PAGE 645, PLAN BOOK 149 PAGE 67 FOR LOTS 1, 2 AND PARCEL A.
  - PARCEL A TO BE CONVEYED FROM THE ESTATE OF MICHAEL CIOLEK, SR. TO ALICIA F. MAGRI & JOHN A. MAGRI.

LEGEND

- IRON PIPE FOUND ○
- IRON PIPE SET ●
- IRON BAR FOUND ⊙
- BOUND FOUND □
- CHAIN LINK FENCE —○—○—
- STOCKADE FENCE —□—□—

APPLICANT/OWNER:  
THE ESTATE OF MICHAEL CIOLEK, SR.  
4 INDUSTRIAL DRIVE  
SOUTH HADLEY, MA 01075

PINE STREET

PLANNING BOARD  
SOUTH HADLEY, MASSACHUSETTS  
APPROVAL UNDER SUBDIVISION  
CONTROL LAW NOT REQUIRED  
DATE \_\_\_\_\_

REGISTRY OF DEEDS  
HAMPSHIRE COUNTY

APPROVAL NOT REQUIRED PLAN OF LAND IN  
SOUTH HADLEY, MASSACHUSETTS  
SURVEYED FOR  
THE ESTATE OF MICHAEL CIOLEK, SR.

SCALE: 1" = 20'

DATE: MARCH 22, 2022

**HERITAGE**  
LAND SURVEYING & ENGINEERING, INC.

241 COLLEGE HIGHWAY & CLARK STREET  
POST OFFICE BOX 90  
SOUTHAMPTON, MASSACHUSETTS 01073-0090  
(413) 527-3600  
INFO@HERITAGESURVEYS.COM

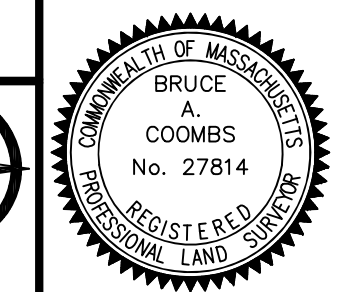
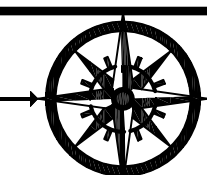

*Bruce A. Coombs*

THIS SURVEY AND PLAN WERE PREPARED IN ACCORDANCE WITH THE RULES AND REGULATIONS OF THE REGISTERS OF DEEDS, AND THE PROCEDURAL AND TECHNICAL STANDARDS FOR THE PRACTICE OF LAND SURVEYING IN THE COMMONWEALTH OF MASSACHUSETTS.

3/22/22 *Bruce A. Coombs*  
DATE REGISTERED LAND SURVEYOR