

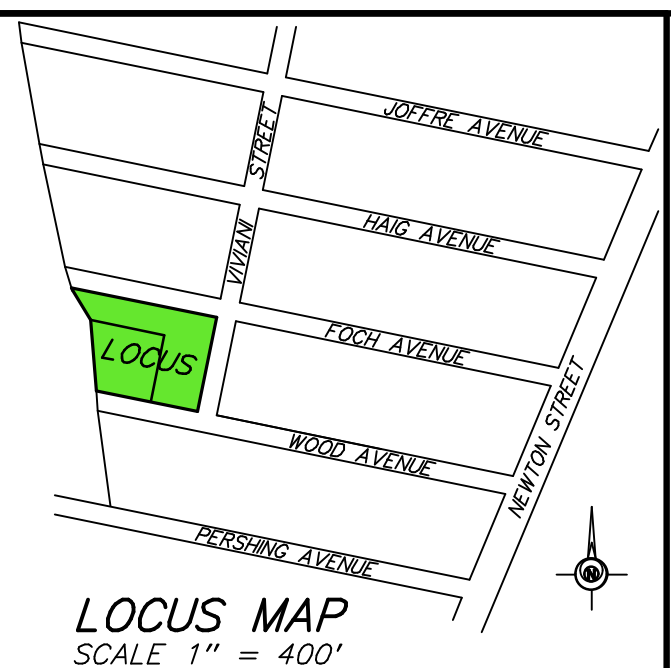

**APPLICANT -**  
**DINO J. MARINELLO**  
No. 199 GRANBY ROAD  
SOUTH HADLEY, MA 01075

**HORIZONTAL DATUM - NAD83**  
NORTH AMERICAN DATUM OF 1983

DATE	NOTES / REVISIONS
NOTE	CONTACT DIG-SAFE PRIOR TO ANY EXCAVATIONS 1-888-344-7233
NOTE	SUBJECT TO EASEMENTS, RESTRICTIONS AND R.O.W.'S OF RECORD, IF ANY AND APPLICABLE.
I CERTIFY THAT THIS PLAN WAS MADE IN ACCORDANCE WITH THE MINIMUM RULES AND REGULATIONS OF THE REGISTRAR OF DEEDS.	
SIGNED	EDWARD J. CHAPDELAINÉ No. 38378.
SCALE 1" = 20'	



**OWNER OF RECORD -**

**PARCEL ID: 0025-0067-000**  
No. 25 WOOD AVENUE  
EDWARD CORCHESNE  
DEED 13402, PAGE 322.  
PLAN 4, PAGE 38.  
ZONE = RESIDENCE A-2

**OWNER OF RECORD -**

**PARCEL ID: 0025-0066-000**  
No. 0 FOCH AVENUE  
EDWARD CORCHESNE  
DEED 13402, PAGE 322.  
PLAN 4, PAGE 38.  
ZONE = RESIDENCE A-2

**PLANNING BOARD**  
SOUTH HADLEY, MASS.

DATE: \_\_\_\_\_

APPROVAL UNDER THE SUBDIVISION CONTROL LAW NOT REQUIRED.

No determination has been made as to the buildability of any lot shown hereon this plan.

SIGNED \_\_\_\_\_

**"SUBDIVISION APPROVAL NOT REQUIRED"**

INDEXED

**PLAN OF LAND IN THE TOWN OF SOUTH HADLEY, MASSACHUSETTS**  
HAMPSHIRE COUNTY - PREPARED FOR  
**DINO J. MARINELLO**

DURKEE, WHITE, TOWNE AND CHAPDELAINÉ  
CIVIL ENGINEERS AND LAND SURVEYORS  
356 FRONT STREET  
CHICOPEE, MASSACHUSETTS - 01013  
PHONE (413) 592-5164

DRAWN BY EJC  
CHECKED BY \_\_\_\_\_  
APPROVED BY EJC  
SCANNED \_\_\_\_\_

DATE: 08/03/2021  
SCALE 1" = 20'

DRAWING No. **82-4394**  
S.2021-155.1

SHEET 1 OF 1  
FILE 2021-155.590