

- NOTES:**
1. THIS PLAN HAS BEEN PRODUCED FOR COORDINATION PURPOSES ONLY WITH THE TOWN OF SOUTH HADLEY AND SHALL NOT BE USED FOR CONSTRUCTION OR THE CONVEYANCE OF LAND.
  2. THE EXISTING CONDITIONS DEPICTED HEREON ARE BASED ON A PARTIAL TOPOGRAPHIC SURVEY PERFORMED BY R LEVESQUE ASSOCIATES, INC. IN OCTOBER 2018. AERIAL IMAGERY AND BOUNDARY-RELATED MATTERS ARE REFERENCED FROM MASSGIS DATABASES.
  3. THE PREMISES SHOWN HEREON ARE A PORTION OF THE SAME AS CONVEYED TO SOUTH HADLEY PLAZA, LLC BY THE DEED RECORDED AT THE HAMPSHIRE COUNTY REGISTRY OF DEEDS IN BOOK 12265, PAGE 36.

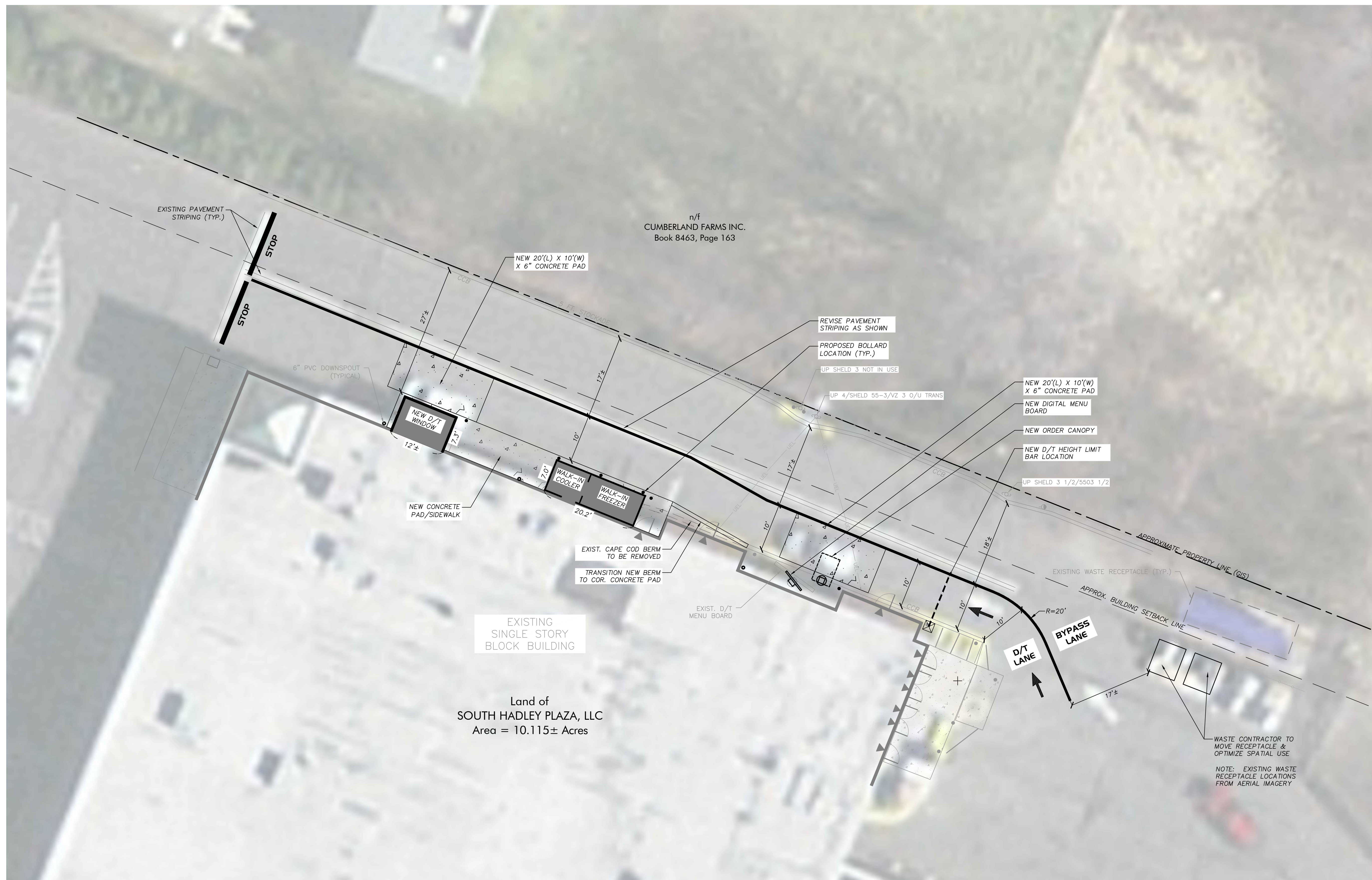

n/f  
CUMBERLAND FARMS INC.  
Book 8463, Page 163

EXISTING  
SINGLE STORY  
BLOCK BUILDING

Land of  
SOUTH HADLEY PLAZA, LLC  
Area = 10.115± Acres

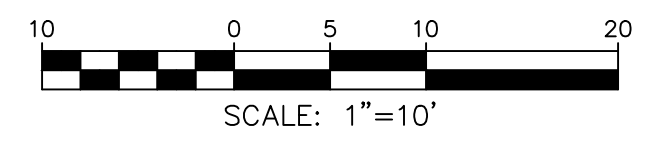

**RLA**  
**R LEVESQUE ASSOCIATES INC.**  
Landscape Architects  
Civil Engineers - Land Surveyors  
Environmental Consultants  
ph: 413.568.0985 fax: 413.568.0986  
40 School Street  
Westfield, MA 01085  
rlaland.com

**SITE PLAN**  
**PROPOSED PICK-UP WINDOW, WALK-IN & DRIVE THRU IMPROVEMENTS**  
**497 Newton Street - South Hadley, Mass.**  
**Assessors parcel 028-0200-000**

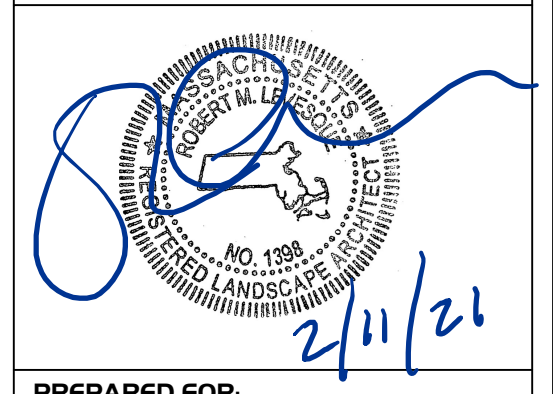

PREPARED FOR:  
Salmar Realty, Inc.  
c/o Mr. Peter Martins  
350 Cottage Street  
Springfield, MA 01104

ISSUANCE DATE:	February 11, 2021
REVISIONS:	DATE:

DRAFTED BY: J.W.M.  
UNAUTHORIZED ALTERATION OF THIS DOCUMENT IS A VIOLATION OF MASSACHUSETTS STATE LAW

SCALE: 1" = 10'  
RLA PROJ. NUMBER: 181016

DRAWING#	REV.
<b>C-1</b>	

**PERMITTING**