

Per Plan Bk. 144 P. 85

Note: The purpose of this plan is to combine all 3 lots owned by Edward F. & Lisa M. Radwilowicz

N/F
Lorelei J.
Crouch
Bk. 6824
Pg. 191

N/F
Richard A.
& Mary A.
Forni
Bk. 2915
Pg. 194

S 87° 25' 52" E
14.72'

R= 65'
L= 22.01'

Waite Avenue

S 81° 39' 10" W
7.12'

N/F
Richard L. &
Lynn M. Felt
Bk. 4581
Pg. 3

S 87° 08' 42" E
231.36'

S 2° 41' 00" W
98.60'

Land of Edward F. & Lisa M.
Radwilowicz

Total Area =
1.23 Acres =
53,420 sq.ft.

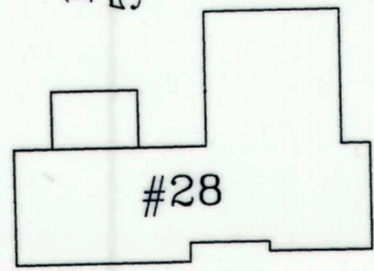

Land of
Jon E. & Kathleen M.
Camp
Bk. 2278 P. 65

S 87° 25' 52" E
90.78'

N/F
Laurie
Narey
Bk. 8835
Pg. 31

S 2° 15' 00" W
98.03'

N 87° 45' 00" W
306.29'

N/F
Tammy J.
O'Neill
Bk. 6335
Pg. 293

Hampshire County
Registry of Deeds
Deed Reference
Bk. 9176 P. 170
Bk. 12907 P. 16

Plan Reference
Bk. 144 P. 85
Bk. 141 P. 92
Bk. 241 P. 80

LEGEND

- Iron Bar Set
- Iron Pipe Found
- Concrete Bound Found

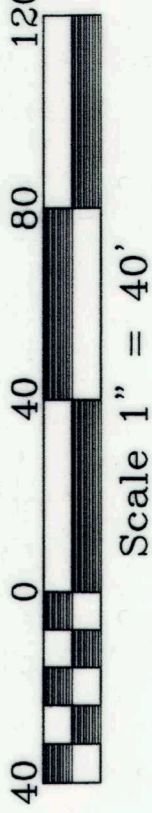

Plan of Land
in

South Hadley, Mass.
owned by
Edward F. and Lisa M.
Radwilowicz

April 26, 2018 1" = 40'

Ronald P. Sassi P.L.S.
52 Cronin Hill Road
Hatfield, Mass.



I certify that this plan has been prepared in conformity with the rules and regulations of the Registrars of Deeds of the Commonwealth of Massachusetts.

Signed: *Ronald P. Sassi*

Date: APR. 26, 2018

PLANNING BOARD
South Hadley, Mass.

Approval under Subdivision Control
Laws is not required.
