

Forest Cutting Plan

Landowner Information Sheet for
Chapter 132 – The Forest Cutting
Practices Act, 304 CMR 11.00
Effective Date: 3/15/16

Please Read **BEFORE** signing your Cutting Plan and keep for your own records.

If you have any questions, call the nearest DCR regional office (listed on page 2) or

mass.gov/dcr/service-forestry

The Massachusetts Forest Cutting Practices Act:

The Massachusetts Forest Cutting Practices Act (the “Act”) requires the improvement, maintenance, and protection of forest lands for the purpose of conserving water, preventing floods and soil erosion, improving the conditions for wildlife and recreation, protecting and improving air and water quality, and providing a continuing and increasing supply of forest products. The Act requires that a Forest Cutting Plan be filed with the appropriate Department of Conservation and Recreation (DCR) Regional office before harvesting timber to ensure that these values are protected. The cutting plan is meant to satisfy the law, reflect **your objectives for your land**, and help you understand the proposed harvest.

Your Objectives:

The most important information on a Forest Cutting Plan is the landowner’s objectives. You will be asked to choose between Long-term Forest Management or a Short-term Harvest. This choice will determine which trees will be harvested and which will remain; **this decision will also determine the future condition of the forest for decades to come.** You will indicate your objective by checking one of two boxes in the Landowner Signature Section on page 4. Information on the two choices is provided below.

Long-term Forest Management

Long-term Forest Management means the planned management of the forest to achieve one or more of the following objectives: produce immediate and maximize long-term income from harvesting activity, maintain or enhance wildlife habitat, improve recreational opportunities, protect soil and water quality, or produce forest specialty products such as maple syrup.

This strategy employs the science and art of forestry to help you manage your property to achieve multiple objectives, preserve future management options, and maximize economic return.

Short-term Harvest

Short-term Harvest means the selection of trees for cutting based on the economic value of individual trees which commonly results in a residual forest stand dominated by poor quality trees and low value species. While this strategy produces immediate income and meets the **minimum** standards of the act, it does little to improve the future condition of the forest. A Short-Term harvest can limit future income and management options by:

- Removing trees before they reach economic maturity
- Leaving little value for future harvests
- Retaining slow growing or poor quality trees
- Removing mostly large diameter or high value species (such as oak) that could act as a seed source for growing future high quality trees or provide food for wildlife

As the landowner, the type of management implemented on your property is ultimately your decision. The DCR hopes you will consider taking a long-term management approach, but most importantly, we want you to make an informed decision by having your forest management options explained. DCR service foresters can provide more information about these options. Contact the nearest office listed below.

Your Responsibilities

A harvest of forest products can have significant impact on your forest and your finances. The cutting plan identifies the standards for cutting, logging, and engineering minimally necessary for protecting the named public values established in the Forest Cutting Practices Act (MGL Ch 132). It is your responsibility to ensure that the harvesting activity complies with the approved forest cutting plan.

The DCR recommends that landowners protect their interests when selling timber. You are encouraged to explore all your options including hiring a licensed professional to plan, oversee or conduct your timber sale, obtaining competitive proposals from licensed foresters for their professional services or inviting competitive bids from licensed loggers. In addition, you should have a separate timber sale contract that addresses your own expectations for items such as payment schedules, road conditions, aesthetics, and other concerns not covered by the Forest Cutting Practices Act and its regulations.

A Forest Management Plan (Chapter 61, Chapter 61A, Forest Stewardship Plans)

The DCR recommends the best way to make decisions about implementing long-term objectives is within the framework of a forest management plan prepared by a Massachusetts licensed forester. Forest management plans provide you with maps, forest stand descriptions, and management recommendations based on objectives that you identify. A forest management plan is one requirement to receive favorable tax treatment for your forestland under M.G.L. Chapter 61 or Chapter 61A. You may also elect to join the Forest Stewardship Program, in which cost-sharing may reimburse a portion of the expense of having a forest management plan prepared. This Stewardship Plan makes you eligible to receive additional cost-share to do a variety of forest management practices. Current DCR policy stipulates that forest cutting plans for forest lands classified under Ch. 61 or 61A or certified under the Forest Stewardship Program must be prepared by a Massachusetts licensed forester or the landowner. Contact a DCR service forester for more information on all of these programs, or visit our website at mass.gov/dcr/service-forestry.

DCR Forestry Offices

Southeastern Massachusetts
(508) 866-2580

Northeastern Massachusetts
(978) 937-2092

Central Massachusetts
(978) 368-0126 ext 127

Connecticut Valley
(413) 545-5752

Berkshires
(413) 442-8928

Forest Cutting Plan

and Notice of Intent under M.G.L.
Chapter 132 – The Forest Cutting
Practices Act, 304 CMR 11.00
(Effective Date: 3/15/16)

For DCR Use Only:

File Number _____ Case No. _____
Date Rec'd _____ Nat. Hert. _____
Earliest Start _____ Pub. Dr. Wat. _____
River Basin _____ ACEC _____
Gen. Obj. _____

Site Information

Location

Town _____
Road _____
Acres _____ Proposed Start Date _____
Vol. MBF _____ Vol. Cds. _____ Vol. Tons _____

Plan Preparer

Name _____
Address _____
Town, State, Zip _____
Phone _____
Type of Preparer _____
*Mass. Forester License # _____
*Required for land under Ch61, Ch61A or Forest Stewardship

Landowner

Name _____
Mailing Address _____
Town, State, Zip _____
Phone _____
Ch61 61A 61B Stew *Case #
FSC CR CR Holder

Licensed Timber Harvester**

Name _____
Address _____
Town, State, Zip _____
Phone _____
Mass. Lic. Harvester # _____
**This information may be supplied after the plan is approved, but before work begins.

Best Management Practices

Stream Crossings

Indicate location on map	SC-1	SC-2	SC-3	SC-4
Type of Crossing				
Existing Structure				
Type of Bottom				
Bank Height (ft)				
Stabilization				

Wetland Crossings

Indicate location on map	WC-1	WC-2	WC-3	WC-4
Length of Crossing				
Mitigation				
Stabilization				

Filter Strips

Indicate location on map	FS-1	FS-2	FS-3	FS-4
Width (50', 100', or VA)				

Harvesting in Wetlands

Indicate location on map	HW-1	HW-2	HW-3	HW-4
Forest Type (see pg 2)				
Acres to be Harvested				
Resid. Basal Area (>50%?)				

Service Forester Comments

Codes

Type of Preparer	Type of Crossing	Stabilization	Mitigation	Type of Bottom
LF Mass. Lic. For.	CU Culvert	SE Seed	FR Frozen	LE Ledge
TH Lic. Tim. Har	BR Bridge	MU Mulch	DR Dry	ST Stony
TB Timber Buyer	FO Ford	CO Corduroy	OT Other	MU Mud
LO Landowner	PO Poled	ST Stone		GR Gravel
OT Other	OT Other	HB Hay Bales		OT Other
		OT Other		

Note:
Applicant must provide DCR with all relevant information before plan may be approved and cutting may begin. Some forestry activities, such as prescribed burning and pesticide or fertilizer application may require additional permits. Consult MA Forestry BMP Manual for further information.

Products to be Harvested*

Species	Mbf/Cds		Mbf/Cds
White Pine		Red Maple	
Red Pine		Sugar Maple	
Pitch Pine		Red Oak	
Hemlock		Black Oak	
Spruce		White Oak	
Other Sftwd.		Other Hdwd.	
White Ash		Total Mbf	
Beech		Cordwood (Cds)	
White Birch		SW Pulp (Tons)	
B & Y Birch		HW Pulp (Tons)	
Black Cherry		Chips (Tons)	

*Note: Volumes indicated in the Plan are as reported by the plan preparer and have not been independently verified by the service forester upon approval. **Mbf** = thousand board feet.

Cutting Standards

Indicate location on map	ST-1	ST-2	ST-3	ST-4
Forest Type				
Acres				
Landowner Objective				
Designation of Trees				
Type of Cut				
Source of Regeneration				

Landowner Signature

The most important information on a cutting plan is the Landowner's objective, as this will determine which trees will be harvested and which will remain; **this decision will also determine the future condition of the forest for decades to come.** After having read the Massachusetts Forest Cutting Plan Information Sheet on page one, indicate your objective by checking the appropriate box below.

LT – Long-term Forest Management

Planned management of the forest to achieve one or more of the following objectives: produce immediate and maximize long-term income, enhance wildlife habitat, improve recreational opportunities, protect soil and water quality, or produce forest specialty products.

ST - Short-term Harvest

Harvest of trees with the main intention of producing short-term income with minimal consideration given to improving the future forest condition, which often results in a forest dominated by poor quality and low value species.

I (we) have read the Massachusetts Cutting Plan Information Sheet, and am aware of my (our) management options.

I (we) hereby certify that I (we) have the legal authority to carry out the operation described above.

I (we) certify that I (we) have notified the Conservation Commission in the town in which the operation is to take place and the abutters of record within two hundred feet of the area to be harvested.

I (we) understand that the volumes in this plan have not been independently verified by the service forester upon approval and will report final values and volumes to the Director or his/her agent if the final figures differ from those reported.

Signature of landowner(s)

Date

Determination and Status

	Approved	Disapproved	Expires	
Cutting Plan	<input type="checkbox"/>	<input type="checkbox"/>	_____	
_____ Signature of Service Forester/Director's Agent		_____ Date		
Extension	1 <input type="checkbox"/>	2 <input type="checkbox"/>	Expires _____ / _____	Ser. For. Ints. _____ / _____
Amendment	App 1 <input type="checkbox"/>	Dis 1 <input type="checkbox"/>	App 2 <input type="checkbox"/>	Dis 2 <input type="checkbox"/>
			_____ / _____	

Final Report and Comments

I hereby certify that the afore described Forest Cutting Plan and all relevant statutes have been substantially complied with.

Signature of Service Forester/Director's Agent

Date

Forest Types				Designation of Trees			Type of Cut		Source of Regeneration				
WP	White Pine	HK	Hemlock	OM	Mixed Oak	CT	Cut Tree	SH	Shelterwood	Intermediate Harvests:	AD	Advanced	
WK	WP/Hem	HH	Hem/Hdwd	RM	Red Maple	LT	Leave Tree	ST	Seed Tree	CT	Commercial Thin	SE	Natural Seed
WH	WP/Hdwd	BC	Blck Cherry	BE	Beech	SB	Stand Boundary	CC	Clear Cut	NT	Non Com Thin	PL	Plant
WO	WP/Oak	BB	Bee/Bir/Map	SF	Spruce/Fir	OT	Other	SE	Selection	Non-Standard Systems:*		CO	Coppice
RP	Red Pine	OH	Oak/Hdwd	SM	Sugar Maple	<u>Landowner Objective</u>		SA	Salvage	HG	Highgrade*	DS	Direct Seed
SR	Red Spruce	OR	N Red Oak	PP	Pitch Pine	LT	Long-term Mgt.	SN	Sanitation	DL	Diameter Limit*	OT	Other
						ST	Short-term Har.			OT	Other*		

*If Other (OT) or a non-standard system is used an explanation must be given on attached narrative page

Stream Crossings

Indicate location on map	SC-5	SC-6	SC-7	SC-8	SC-9	SC-10
Type of Crossing						
Existing Structure						
Type of Bottom						
Bank Height (ft)						
Stabilization						

Wetland Crossings

Indicate location on map	WC-5	WC-6	WC-7	WC-8	WC-9	WC-10
Length						
Mitigation						
Stabilization						

Filter Strips

Indicate location on map	FS-5	FS-6	FS-7	7o-8	7o-9	7o-10
Width (50',100' or VA)						

Harvesting in Wetlands

Indicate location on map	HW-5	HW-6	HW-7	HW-8	HW-9	HW-10
Forest Type (see pg 2)						
Acres to be Harvested						
Resid. Basal Area (>50%)						

<u>Type of Crossing</u>	<u>Stabilization</u>	<u>Mitigation</u>	<u>Type of Bottom</u>
CU Culvert	SE Seed	FR Frozen	LE Ledge
BR Bridge	MU Mulch	DR Dry	ST Stony
FO Ford	CO Corduroy	OT Other	MU Mud
PO Poled	ST Stone		GR Gravel
OT Other	HB Hay Bales		OT Other
	OT Other		

Note:
 Applicant must provide DCR with all relevant information before plan may be approved and cutting may begin. Some forestry activities, such as prescribed burning and pesticide or fertilizer application may require additional permits. Consult MA Forestry BMP Manual for further information.

If Other (OT) is used in any category an explanation must be given on narrative page

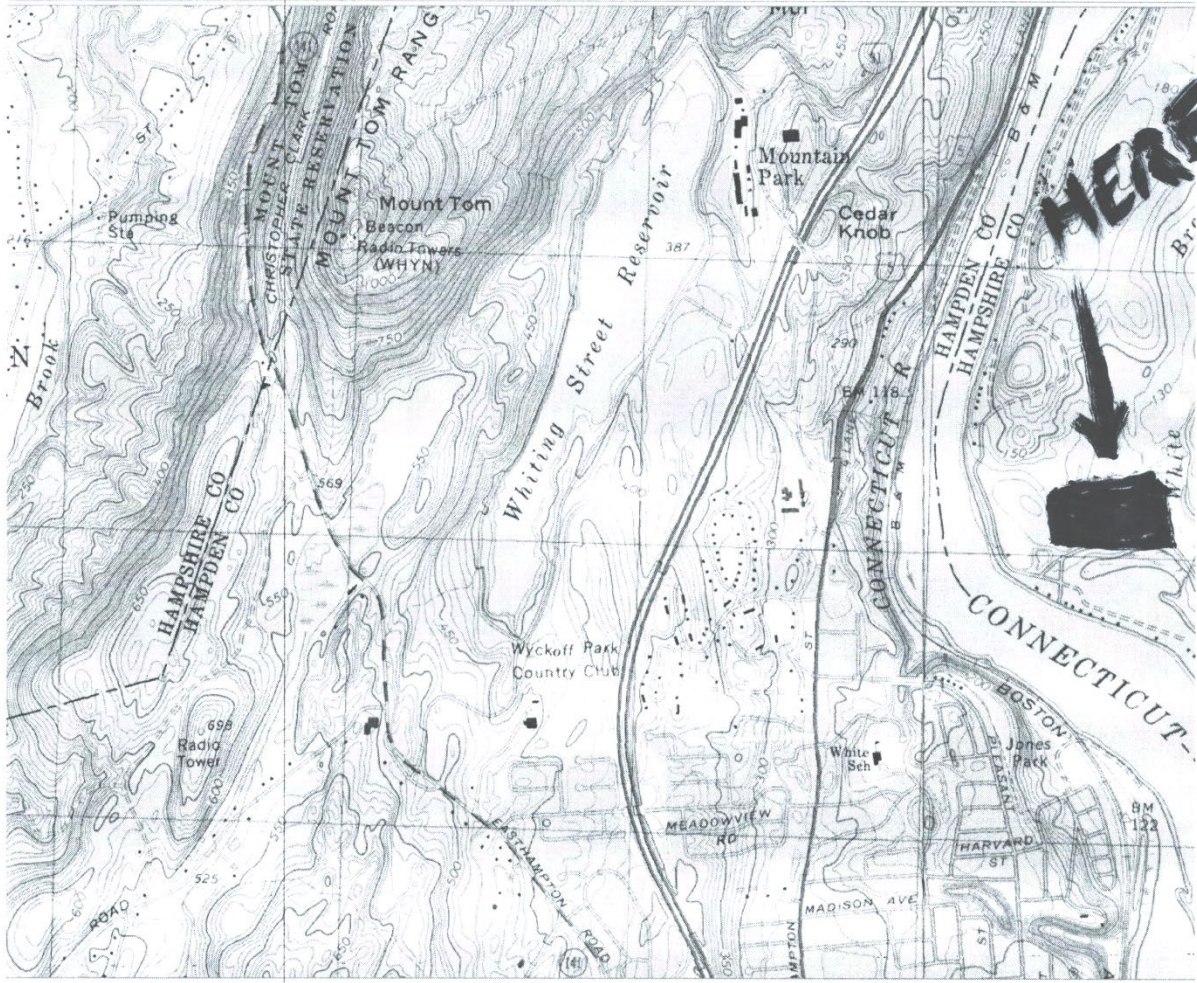

PROPERTY MAP of PAUL BODDREAU
SOUTH HADLEY

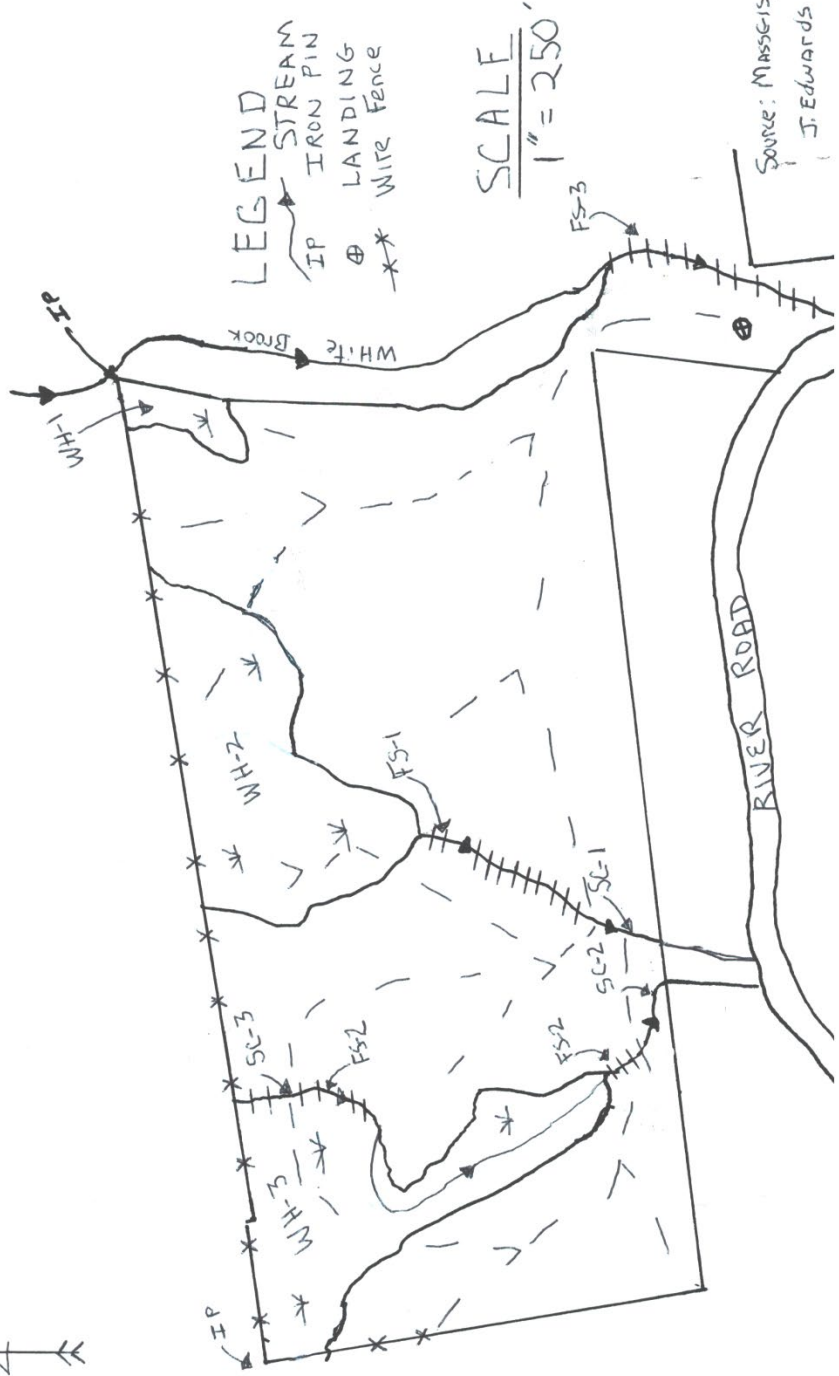

Source: MASSGIS, Assessors
J. Edwards 2021