

This drawing is not intended nor shall it be used for construction purposes unless the signed professional seal of a registered landscape architect, civil engineer or land surveyor employed by The Berkshire Design Group, Inc. is affixed above.

Do not scale drawing for quantity take-offs or construction. Use written dimensions only. If dimensions are incomplete, contact The Berkshire Design Group Inc. for clarification.

© Copyright The Berkshire Design Group, Inc.
This drawing and all of its contents are the express property of The Berkshire Design Group, Inc. and shall not be copied or used in any way without the written consent of The Berkshire Design Group, Inc.

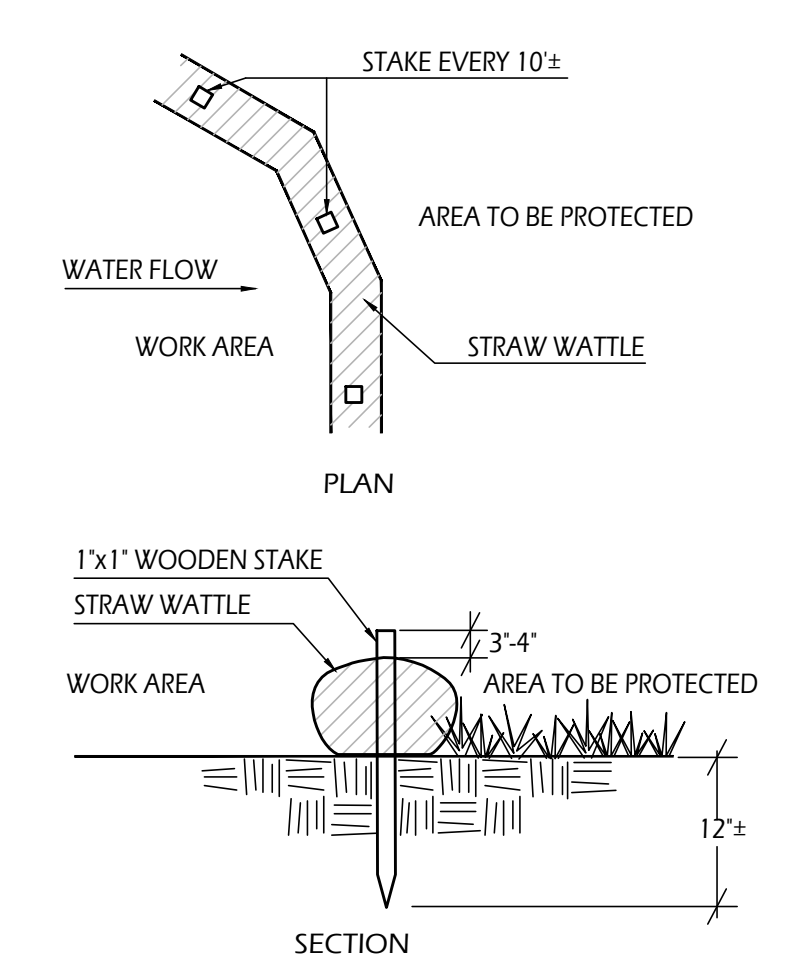
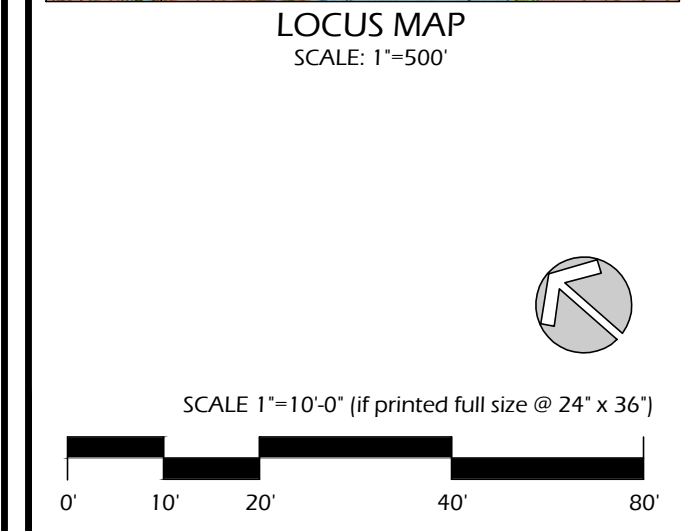
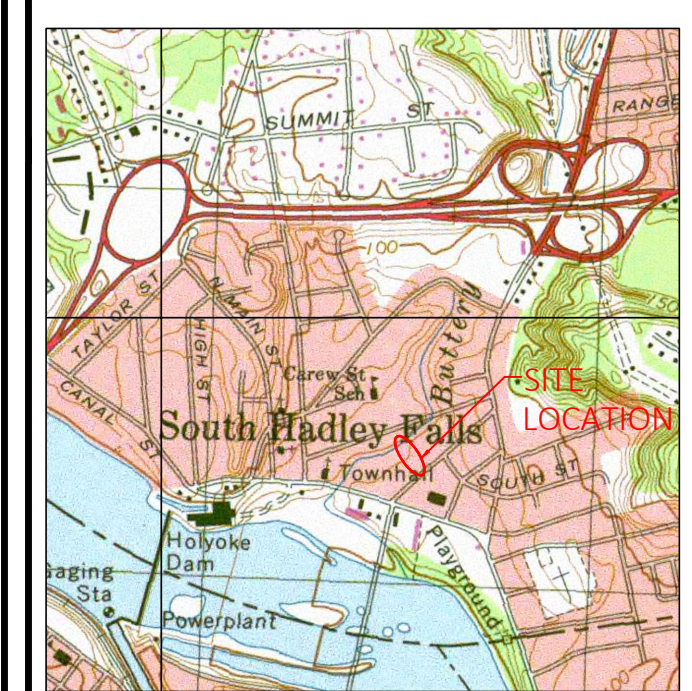

1 Straw Wattle
L1 Not to Scale

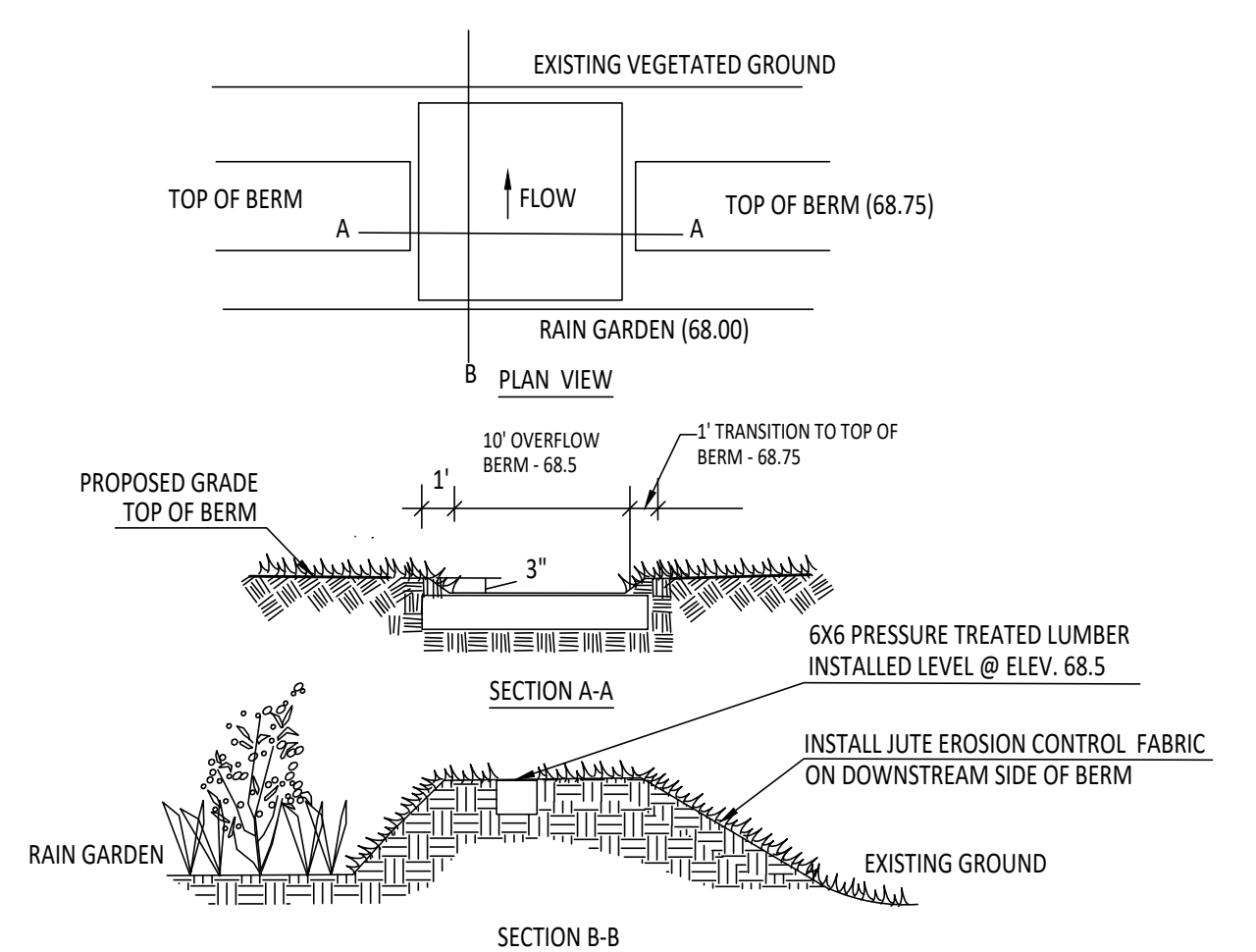

2 Level Spreader
L1 Not to Scale

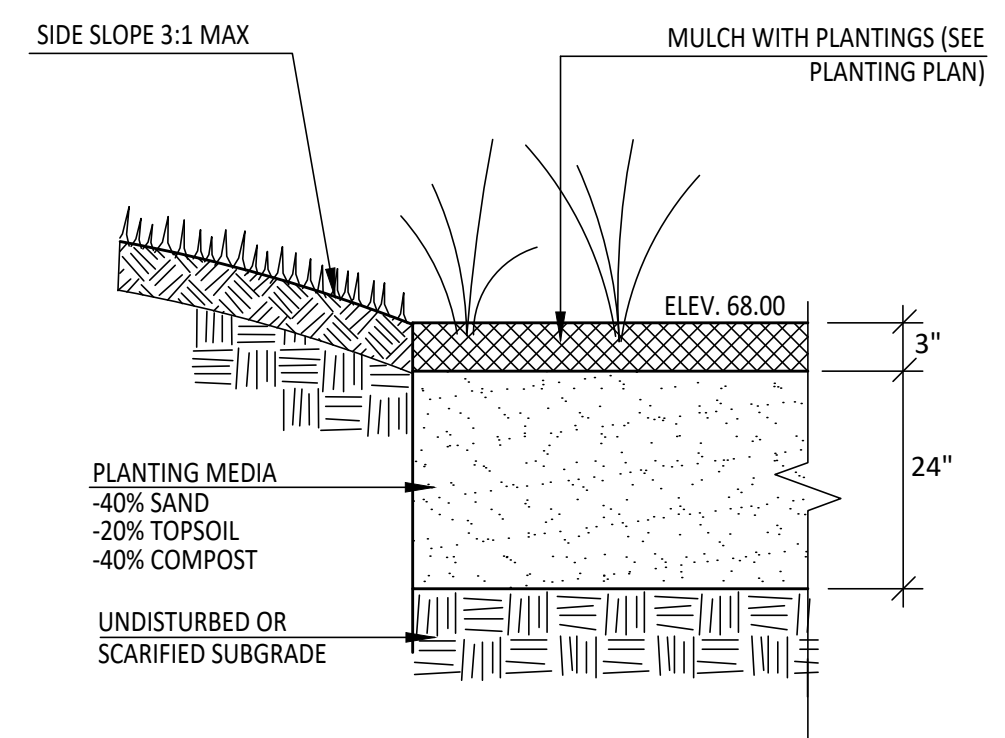

3 Rain Garden Section
L1 Not to Scale

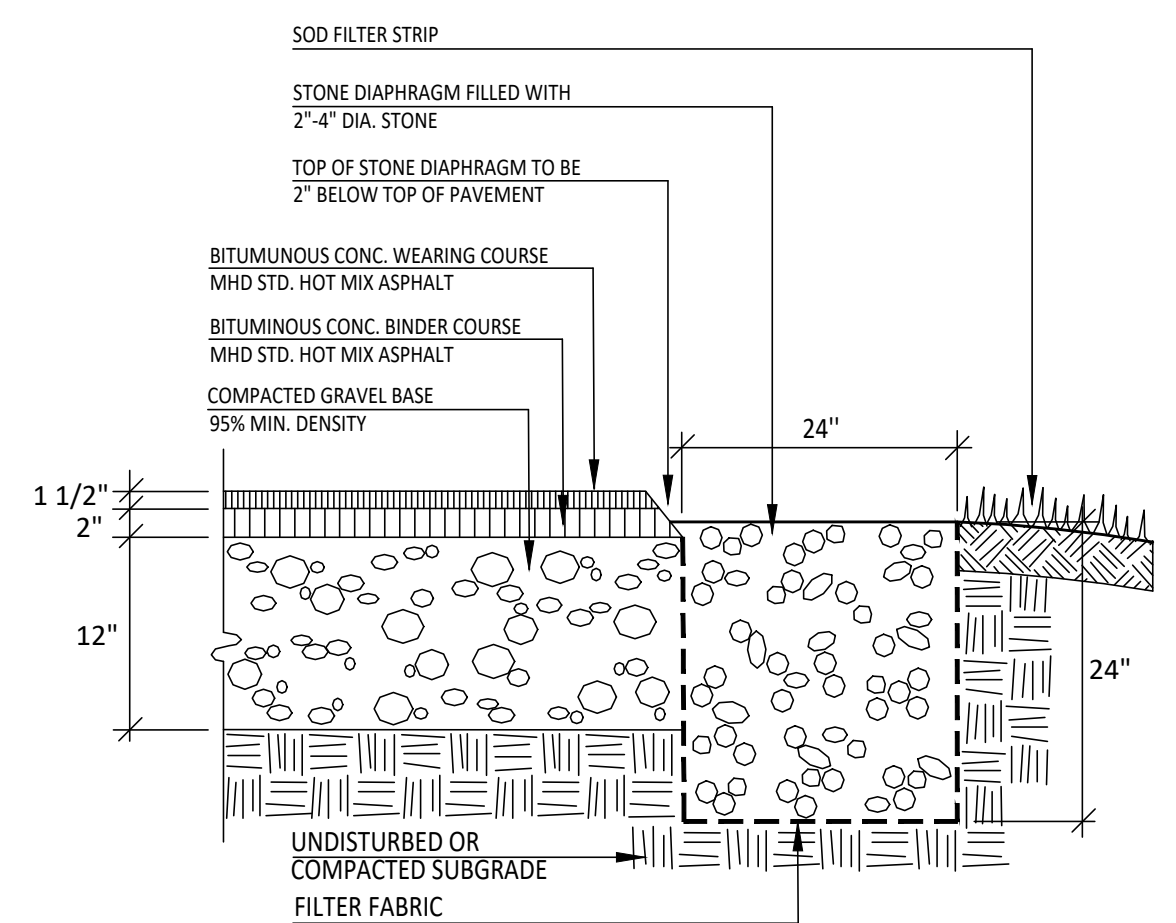

4 Stone Diaphragm
L1 Not to Scale

Plant List

KEY	QTY	LATIN	COMMON	SIZE	NOTES
AA	12	<i>Aronia arbutifolia</i>	Red Chokeberry	18"-24"	
AP	2	<i>Acer pensylvanicum</i>	Striped Maple	5'-6' ht.	
BNH	1	<i>Betula nigra 'Heritage'</i>	Heritage River Birch	7'-8' ht.	multi-stem
CAH	9	<i>Clethra alnifolia 'Hummingbird'</i>	Summersweet	24"-36"	pink
CS	3	<i>Cornus sericea</i>	Red-twig Dogwood	24"-36"	
IV	8	<i>Itea virginica</i>	Sweetspire	18"-24"	white
IVR	17	<i>Ilex verticillata 'Red Sprite'</i>	Red Sprite Winterberry Holly	24"-36"	
NS	3	<i>Nyssa sylvatica</i>	Black Gum	1.5"-2" cal.	
SC	6	<i>Sambucus canadensis</i>	Black Elderberry	24"-36"	
ST	15	<i>Spiraea tomentosa</i>	Steeplebush	15"-18"	pink
VA	5	<i>Viburnum acerifolium</i>	Mapleleaf Viburnum	24"-36"	
VD	7	<i>Viburnum dentatum</i>	Arrowwood Viburnum	24"-36"	

Conservation Seed Mix

NEW ENGLAND CONSERVATION/WILDLIFE SEED MIX	
SPECIES	PERCENT (Raw Seed)
Big Bluestem (<i>Andropogon gerardii</i>)	20
Little Bluestem (<i>Scizachyrium scoparium</i>)	20
Switchgrass (<i>Panicum virgatum</i>)	20
Fox Sedge (<i>Carex vulpinoidea</i>)	10
Silky Wild Rye (<i>Elymus villosus</i>)	8
Common Milkweed (<i>Asclepias syriaca</i>)	5
Deertongue (<i>Panicum clandestinum</i>)	5
Pennsylvania Smartweed (<i>Polygonum pensylvanicum</i>)	5
Partridge Pea (<i>Chamaecrista fasciculata</i>)	4
Silky Smooth Aster (<i>Aster laevis</i>)	1.5
Nodding Bur Marigold (<i>Bidens cernua</i>)	1
Flat-top Aster (<i>Aster umbellatus</i>)	0.5
TOTAL	100

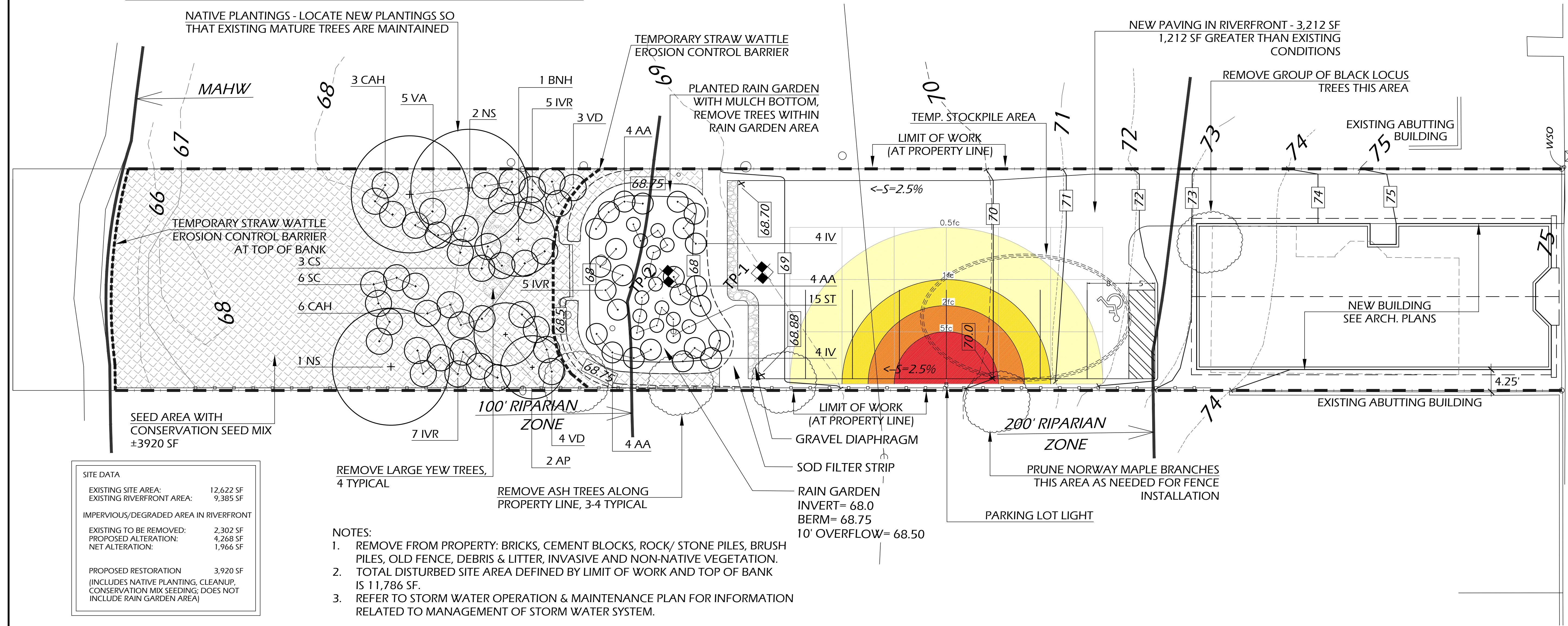

SITE DATA

EXISTING SITE AREA:	12,622 SF
EXISTING RIVERFRONT AREA:	9,385 SF
IMPERVIOUS/DEGRADED AREA IN RIVERFRONT	
EXISTING TO BE REMOVED:	2,302 SF
PROPOSED ALTERATION:	4,268 SF
NET ALTERATION:	1,966 SF
PROPOSED RESTORATION	
(INCLUDES NATIVE PLANTING, CLEANUP, CONSERVATION MIX SEEDING; DOES NOT INCLUDE RAIN GARDEN AREA)	3,920 SF

- NOTES:**
- REMOVE FROM PROPERTY: BRICKS, CEMENT BLOCKS, ROCK/ STONE PILES, BRUSH PILES, OLD FENCE, DEBRIS & LITTER, INVASIVE AND NON-NATIVE VEGETATION.
 - TOTAL DISTURBED SITE AREA DEFINED BY LIMIT OF WORK AND TOP OF BANK IS 11,786 SF.
 - REFER TO STORM WATER OPERATION & MAINTENANCE PLAN FOR INFORMATION RELATED TO MANAGEMENT OF STORM WATER SYSTEM.

Site Plan

Revisions

2/24/2020	Add HC Space
-----------	--------------

Date: Jan. 22, 2020
Scale: 1"=10'
Drawn By: Staff
Checked By: MYL

Sheet Number: **L1**