

1 Straw Wattle
 L1 Not to Scale

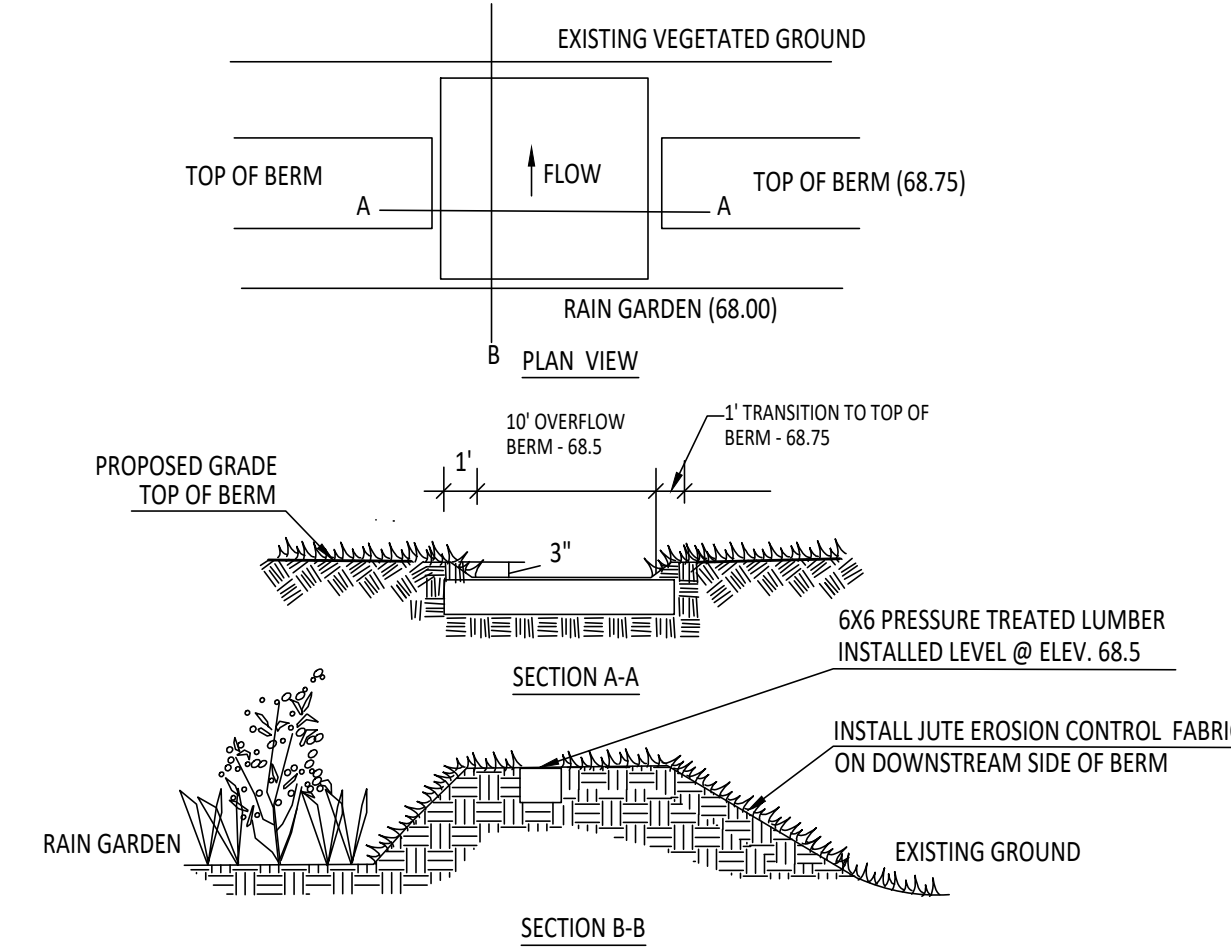

2 Level Spreader
 L1 Not to Scale

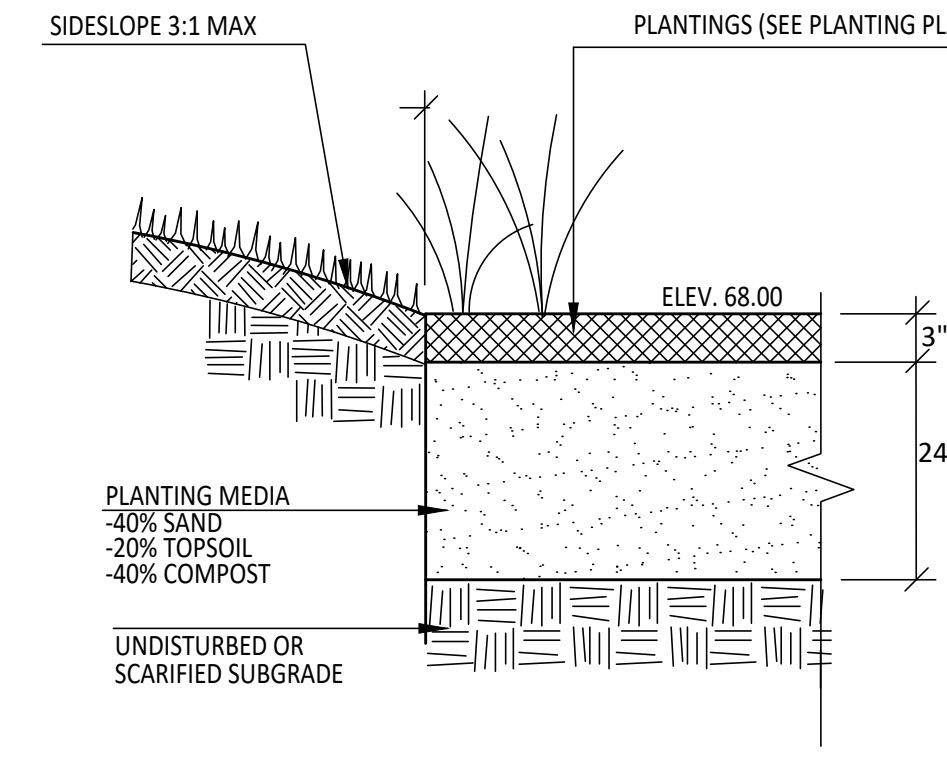

3 Rain Garden Section
 L1 Not to Scale

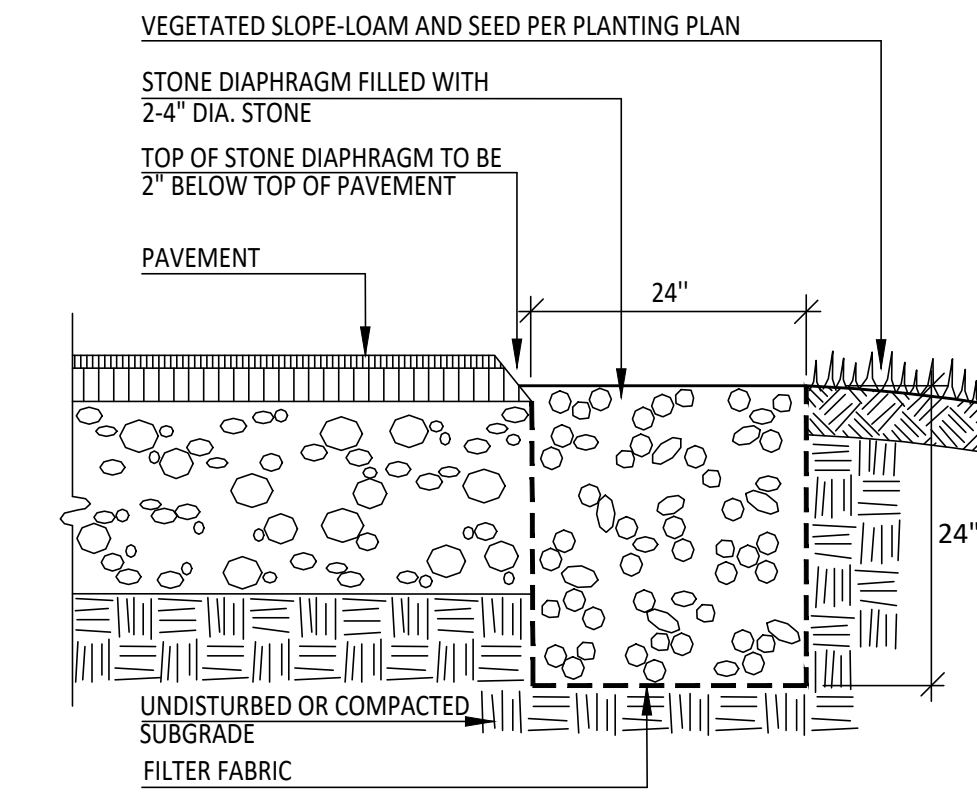

4 Stone Diaphragm
 L1 Not to Scale

Plant List

KEY	QTY	LATIN	COMMON	SIZE	NOTES
AP	2	<i>Acer pensylvanicum</i>	Striped Maple	5'-6" ht.	
BNH	1	<i>Betula nigra</i> 'Heritage'	Heritage River Birch	7'-8" ht.	multi-stem
CAH	9	<i>Clethra alnifolia</i> 'Hummingbird'	Summersweet	24"-36"	pink
CS	3	<i>Cornus sericea</i>	Red-twig Dogwood	24"-36"	
IV	12	<i>Ilex verticillata</i>	Winterberry Holly	24"-36"	
NS	3	<i>Nyssa sylvatica</i>	Black Gum	1.5"-2" cal.	
SC	6	<i>Sambucus canadensis</i>	Black Elderberry	24"-36"	
VA	5	<i>Viburnum acerifolium</i>	Mapleleaf Viburnum	24"-36"	
VD	7	<i>Viburnum dentatum</i>	Arrowwood Viburnum	24"-36"	

Conservation Seed Mix

NEW ENGLAND CONSERVATION/WILDLIFE SEED MIX	
SPECIES	PERCENT (Raw Seed)
Big Bluestem (<i>Andropogon gerardii</i>)	20
Little Bluestem (<i>Schizachyrium scoparium</i>)	20
Switchgrass (<i>Panicum virgatum</i>)	20
Fox Sedge (<i>Carex vulpinoidea</i>)	10
Silky Wild Rye (<i>Elymus villosus</i>)	8
Common Milkweed (<i>Asclepias syriaca</i>)	5
Deertongue (<i>Panicum clandestinum</i>)	5
Pennsylvania Smartweed (<i>Polygonum pensylvanicum</i>)	5
Partridge Pea (<i>Chamaecrista fasciculata</i>)	4
Silky Smooth Aster (<i>Aster laevis</i>)	1.5
Nodding Bur Marigold (<i>Bidens cernua</i>)	1
Flat-top Aster (<i>Aster umbellatus</i>)	0.5
TOTAL	100

NATIVE PLANTINGS - LOCATE NEW PLANTINGS SO THAT EXISTING MATURE TREES ARE MAINTAINED

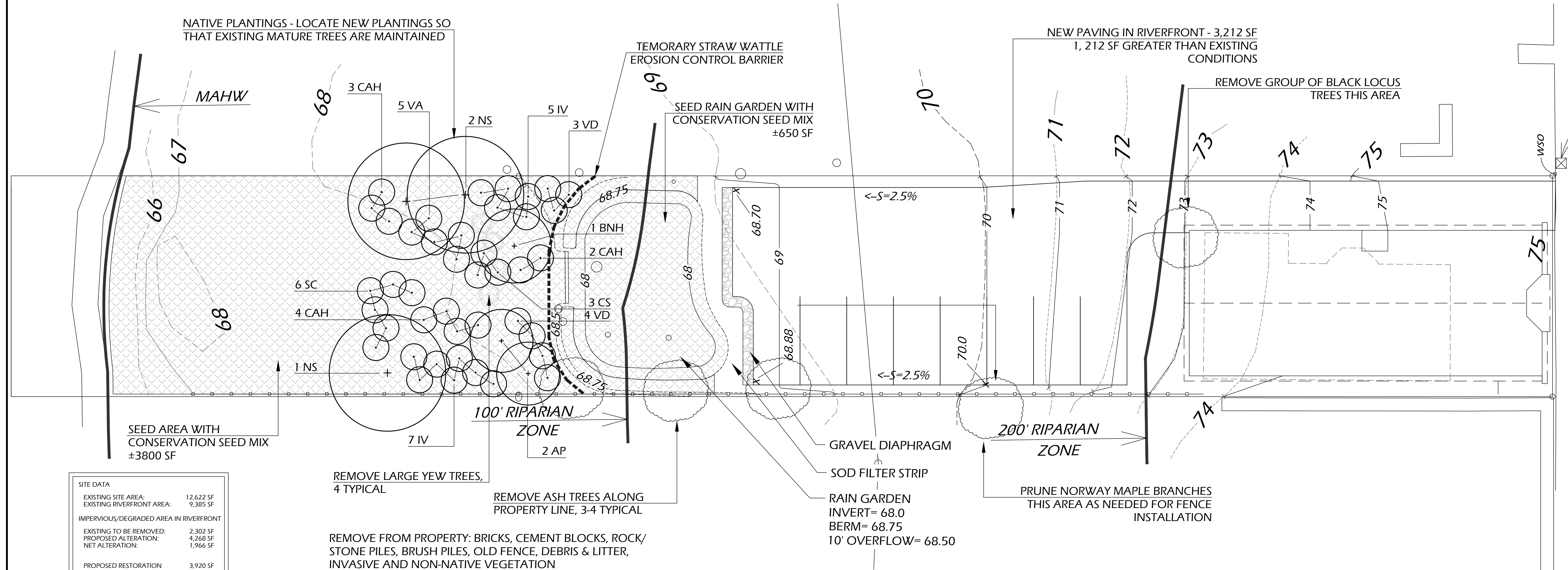

SITE DATA

EXISTING SITE AREA:	12,622 SF
EXISTING RIVERFRONT AREA:	9,385 SF
IMPERVIOUS/DEGRADED AREA IN RIVERFRONT	
EXISTING TO BE REMOVED:	2,302 SF
PROPOSED ALTERATION:	4,268 SF
NET ALTERATION:	1,966 SF
PROPOSED RESTORATION	3,920 SF
(INCLUDES NATIVE PLANTING, CLEANUP, CONSERVATION MIX SEEDING; DOES NOT INCLUDE RAIN GARDEN AREA)	

REMOVE LARGE YEWE TREES, 4 TYPICAL

REMOVE FROM PROPERTY: BRICKS, CEMENT BLOCKS, ROCK/STONE PILES, BRUSH PILES, OLD FENCE, DEBRIS & LITTER, INVASIVE AND NON-NATIVE VEGETATION

GRAVEL DIAPHRAGM

SOD FILTER STRIP

RAIN GARDEN
 INVERT= 68.0
 BERM= 68.75
 10' OVERFLOW= 68.50

PRUNE NORWAY MAPLE BRANCHES THIS AREA AS NEEDED FOR FENCE INSTALLATION

This drawing is not intended nor shall it be used for construction purposes unless the signed professional seal of a registered landscape architect, civil engineer or land surveyor employed by The Berkshire Design Group, Inc. is affixed above.

Do not scale drawing for quantity take-offs or construction. Use written dimensions only. If dimensions are incomplete, contact The Berkshire Design Group Inc. for clarification.

© Copyright The Berkshire Design Group, Inc.
 This drawing and all of its contents are the express property of The Berkshire Design Group, Inc. and shall not be copied or used in any way without the written consent of The Berkshire Design Group, Inc.

Restoration and Drainage Plan

Revisions
 DEP Comments 08-26-219

Date: July 24, 2019
 Scale: 1"=10'
 Drawn By: Staff
 Checked By: MYL

L1