



Richard Harris <rharris@southhadleyma.gov>

Fwd: CHD sewer service

Jim Reidy <jreidy@southhadleyma.gov>
To: Richard Harris <rharris@southhadleyma.gov>
Cc: Vivian Price <vprice@southhadleyma.gov>

Tue, Mar 19, 2019 at 3:43 PM

Hi Richard,

As we discussed, I met with representatives from Associated Builders to discuss the proposed CHD sewer service. They originally proposed connecting the building's sewer service to the service line for the Big Y plaza. I missed this when I did my initial plan review. Today I told them they would have to get permission from Big Y to connect to the Big Y service or they could connect the CHD sewer service to the Town sewer main across the street on Old Lyman Road.

Associated Builders has decided to connect the CHD sewer service to the sewer main on Old Lyman Road. Please see the email exchange below

Thanks,
Jim

Jim Reidy
South Hadley DPW Superintendent
10 Industrial Drive
South Hadley, MA 01075
Phone: 413-538-5033



----- Forwarded message -----
From: **Jim Reidy** <jreidy@southhadleyma.gov>
Date: Tue, Mar 19, 2019 at 3:33 PM
Subject: Re: CHD sewer service
To: Timothy Houle <tah@abuilders.com>
Cc: Kimberly Masiuk <kmm@abuilders.com>

Hi Tim and Kim,

I do not generally require flowable fill. If the material you remove is suitable (we think it will be), then I am okay with you bedding the pipe in stone, backfilling with the suitable material that came out of the trench, and compacting it in one foot lifts. You must match the asphalt thickness in the road and there must be a foot of compacted gravel under the asphalt.

Thanks,
Jim

Jim Reidy
South Hadley DPW Superintendent
10 Industrial Drive
South Hadley, MA 01075
Phone: 413-538-5033

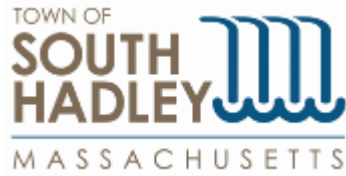

On Tue, Mar 19, 2019 at 2:16 PM Timothy Houle <tah@builders.com> wrote:

Hi Jim,

-

Attached is a detail of the sewer tie-in we are proposing. Tom Ciolek wants to do a 45 degree saddle wye at the main and a cleanout 10 feet outside the building. Let me know if you have any comments/revisions.

-

NOTES:

1. ALL SEWER PIPE SHALL HAVE A MINIMUM DEPTH OF 4' FROM TOP OF PIPE TO FINISH GRADE. IF 4' OF COVER IS NOT POSSIBLE PIPE SHALL BE INSULATED.
2. ALL SERVICE PIPING SHALL BE 6" DIAMETER PVC SDR 35.

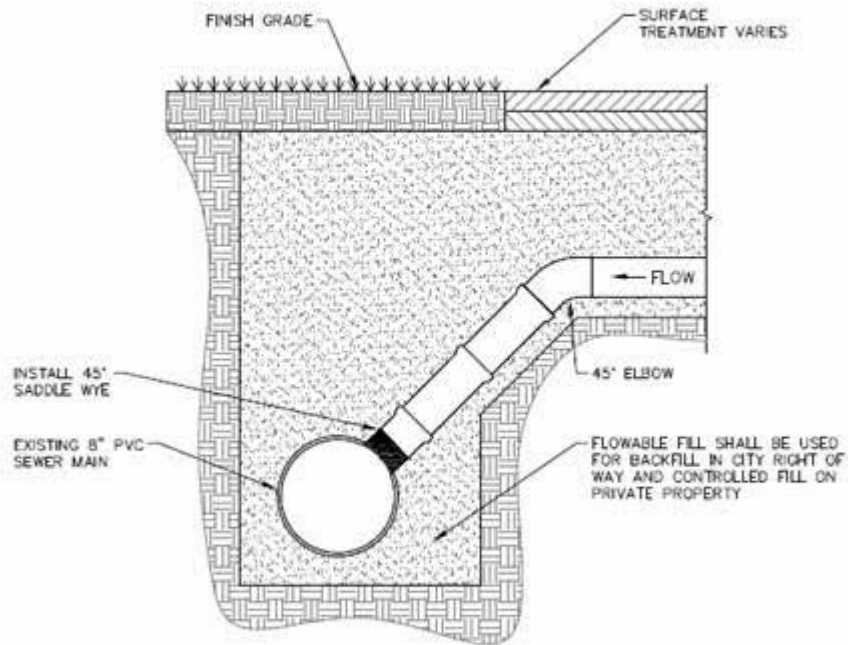

SANITARY SEWER WYE CONNECTION

SCALE: N.T.S

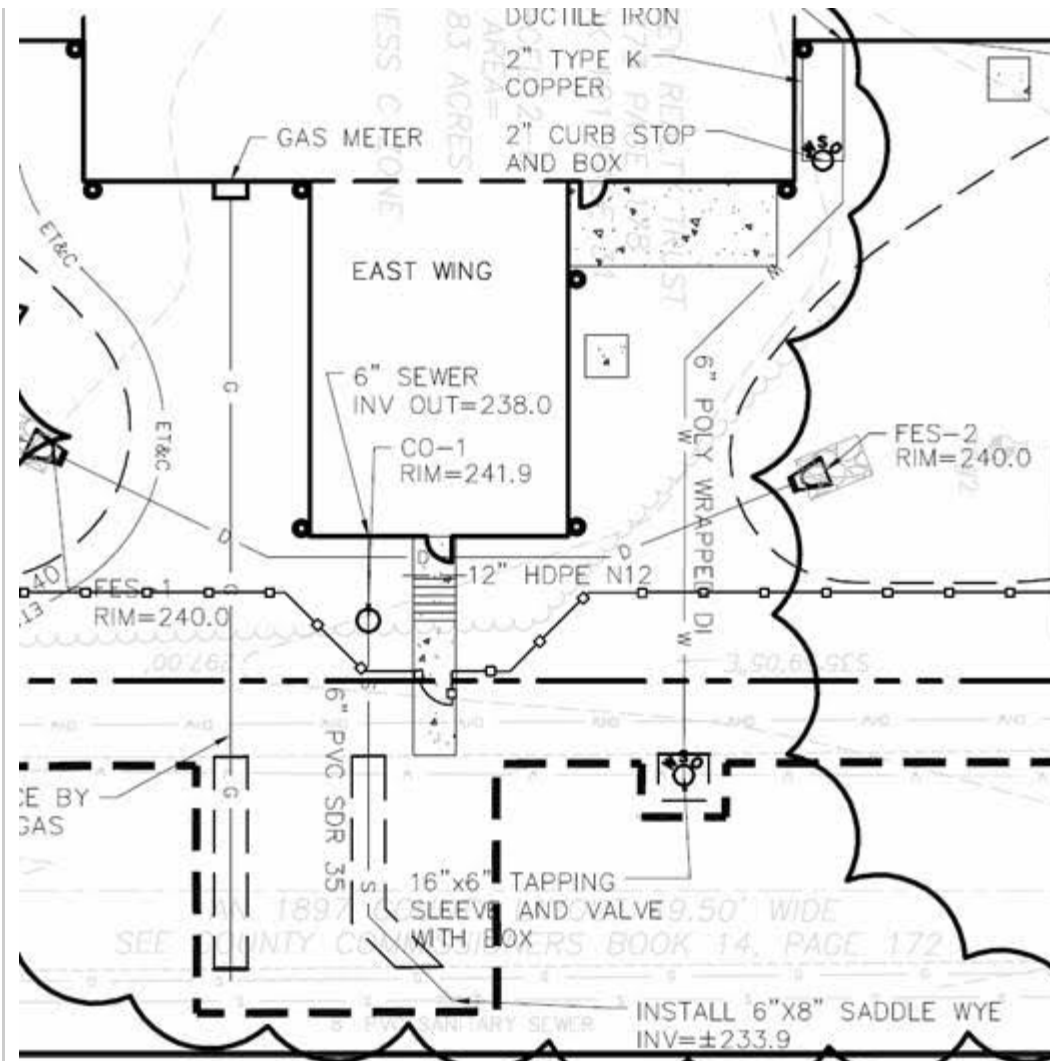

Thanks,

Tim Houle

Associated Builders, Inc.

4 Industrial Drive, South Hadley, MA 01075

Ph 413.536.0021 Fax 413.536.0908

www.abuilders.com

All electronic documents, including plans, shall remain the sole and exclusive property of Associated Builders, Inc. Any plans provided shall not be altered or expanded upon. With permission, plan data can be used as base data for plans subsequently produced for the project

by a project supplier or subcontractor, provided that appropriate credits are made for the base data, and such plans do not give the appearance of being prepared, endorsed or certified by Associated Builders, Inc. No guarantee to the accuracy of the files is expressed or implied.

-